



panoramic™
full visual system



the other guys



panoramic™
full visual system

PANORAMIC™ FULL VISUAL SYSTEM

Panoramic is a revolutionary modular exhibit system which offers a seamless fabric graphic, completely covering the display structure. Panoramic is the most effective visual system combining aluminum profile structures with tension fabric graphics.



Modular Exhibit (Wikipedia)

- ◆ Modular exhibit systems use a standardized basic structure, whether this be a metal frame work, or thin, lightweight panel construction, which is then configured within the confines of the structure limitations to what the exhibitor requires.
- ◆ A study by Trade Show Week Magazine showed that modular exhibits weigh, on average, about 60% less than traditional custom exhibits. Analogous to a Lego or Tinker-toy, the components are typically easily reconfigured into new layouts as the exhibitor may require from show to show.
- ◆ The components are often made from very lightweight materials, and transported in small traveling cases (often injection molded plastic).

pan•o•ram•a (pn-rm, -rām)n.

- ◆ a : an unobstructed or complete view of an area in every direction
- ◆ b : a comprehensive presentation of a subject

“ A sleek and durable rendering ”



ARCHITECTURAL RENDERING

Panoramic is a modular exhibit system that virtually disappears behind beautiful fabric graphics that fully cover its structure

“

Expand
your brand

”

SEAMLESS COMMUNICATION

Printed using dye-sublimation on fabric, Panoramic's graphics are seamless and offer a quality of contrast, intensity, and depth that is unparalleled. Your message is not interrupted, but rather, is rendered even stronger.



“Why?”

“What if the true revolution was in fabric printing ?”

DYE-SUBLIMATION PRINTING

Sublimation is the physics phenomenon by which a material passes directly from a solid state to a gaseous state. Using this printing process, the fabric fibers are directly dyed, which improves the durability of their colors over time.

INTENSE COLORS

Professionals agree, dye-sublimation printing offers a quality of contrast, intensity, and a depth that is unparalleled. All of the colors in this large line are incredibly bright, including high intensity blacks.

ANTI-REFLECT

The sublimated fabric absorbs light and as a result avoids any reflections on your image. Your image is thus more readable in any situation.

ENVIRONMENTALLY-FRIENDLY PROCESS

The printing process and the inks that are used are environmental solutions without solvent and without harsh odors.

VARIED MATERIALS

A large line of fabrics multiplies the variety of possible configurations and leaves ample room for your unique designs. This broad choice of materials gives you the ability to create original graphics with boundless creativity.

A MATERIAL ADAPTED TO TRADESHOW CONDITIONS

Fabric graphics enable easy transport, installation, and manipulation. They do not require special packaging and are resistant to scratches and stains. Furthermore, fabric graphics are completely washable and can even be dry-cleaned.

“Though the structure is out of sight, it is never out of mind.”

DETAILS WHICH MAKE A DIFFERENCE

- Durable and lightweight aluminium structure
- White anodized profiles for perfect coordination with your graphic
 - Up to 40% less pieces in comparison to similar systems
 - Wire management system for no visible wires on your exhibit
- Packaging includes a foam interior in order to separate each profile for shipping and storing
 - Compatible with a number of accessories that are already available



“Quick & stress-free setup”

1 **SET UP**
Each configuration is pre-mounted: the caps are attached to the aluminum profiles and the parts are engraved.

2&3 **NO TOOLS NECESSARY...**
The profiles are assembled without tools thanks to an angled bracket that is invisible after set-up.

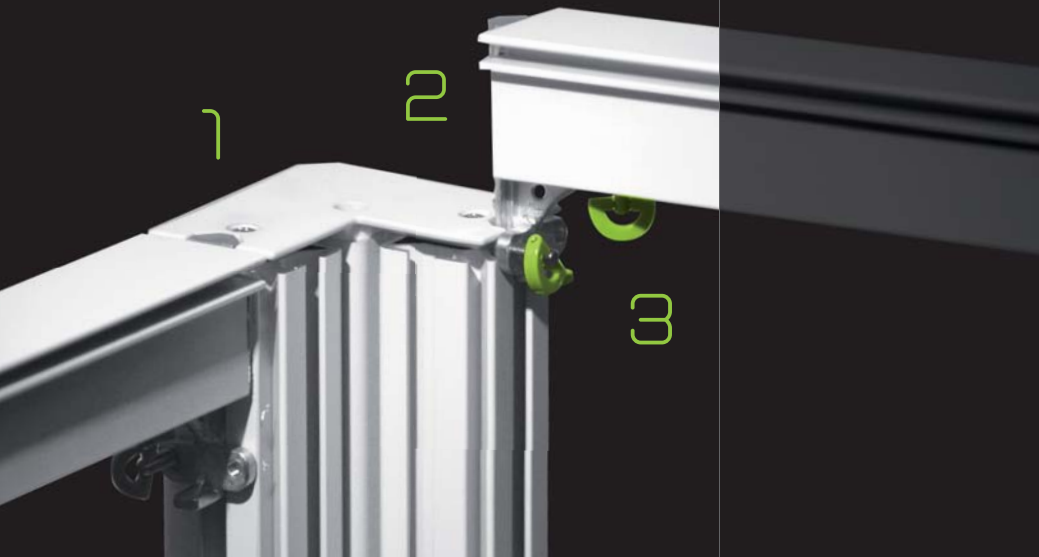

“Putting up your booth has never been this simple”

“Manage your costs & logistics”

GRAPHIC INSTALLATION

With silicone edge on every side, your graphic is easily inserted into the aluminum profiles, and is always perfectly stretched without wrinkles.

GRAPHIC TRANSPORT

A simple envelope is enough to transport the graphics covering your stand. However, Panoramic is also moving forward to offer exclusive packaging solutions.

COST OF USE

With up to 40% less materials than configurations of the same size in other systems, with Panoramic, your set-up time is optimized and transport and storage are more economical.

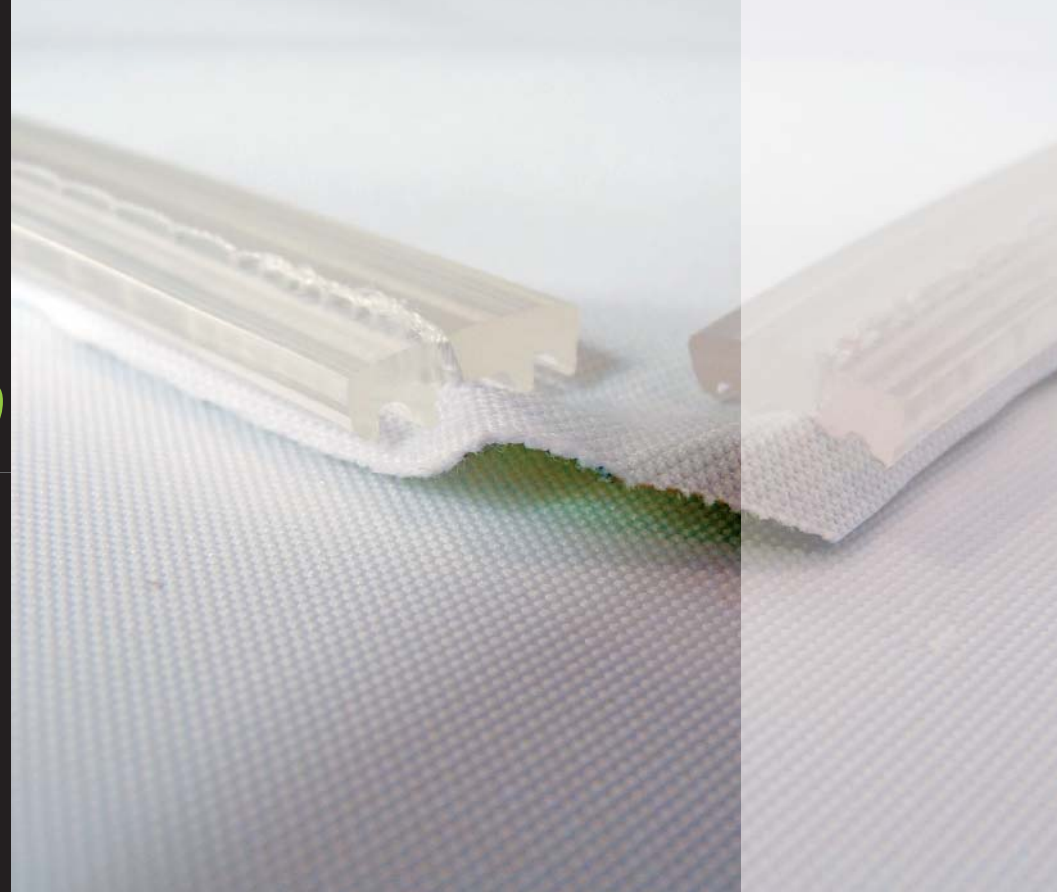

MODULAR PACKAGING SYSTEM

Panoramic utilizes stackable cases which permit individual packaging for each module of your exhibit, allowing you to better organize each step of your set-up and dismantle. These cases also make it easy to bring only one or a few parts of the booth, according to the requirements of your event.



“Panoramic™
Choose
between kits,
exhibit
components,
or complete
designability!”

Kits



L BOOTH 3x3 with storage area

3d PAN-STAND-4

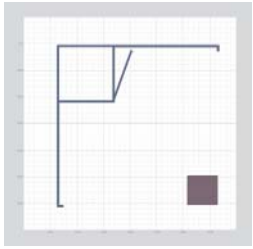

L BOOTH 3x6

3d PAN-STAND-6

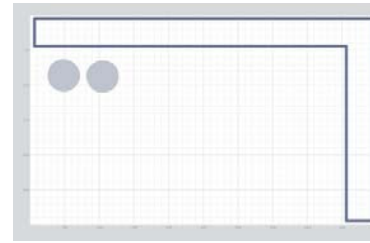

L BOOTH 3x6 tower + storage area

3d PAN-STAND-5

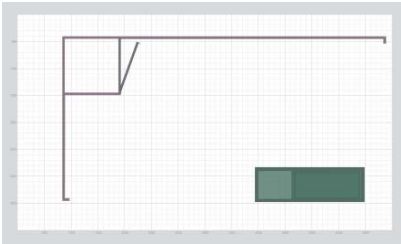

WALL 3x6 with storage area

3d PAN-STAND-7

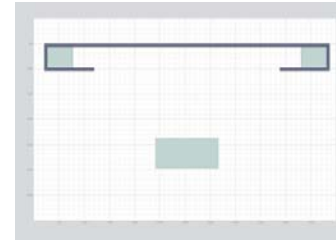

Zig Zag BOOTH 3x6

3d PAN-STAND-8



BOOTH 3x3

3d PAN-STAND-10

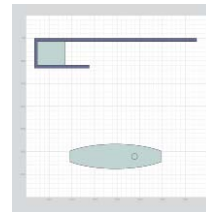

U BOOTH 3x3

3d PAN-STAND-9

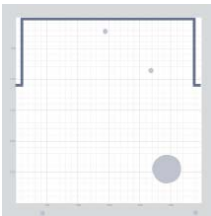

BOOTH + curve 3x3

3d PAN-STAND-11

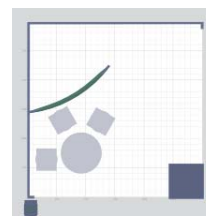

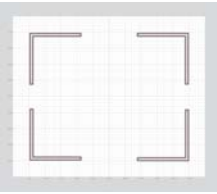

4 L BOOTH 6x5

3d PAN-STAND-12

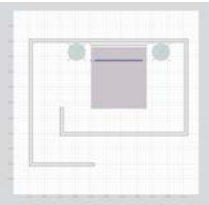
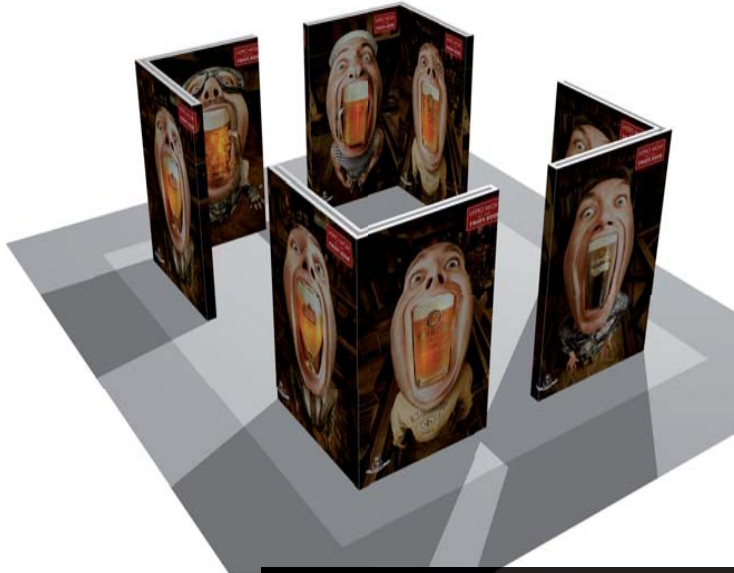

ROOM 6x6

3d PAN-STAND-13



Exhibit components



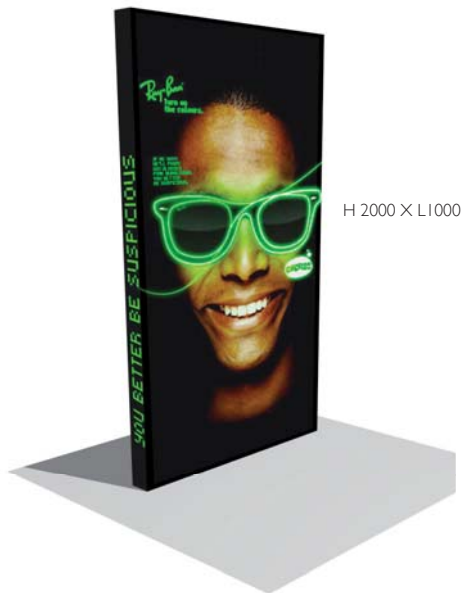

H 2000 X L 1000

LIGHT BOX

3d PAN-MODULE-1
created by ddb



LED



COUNTER + TOWER

3d PAN-COUNT-4
created by ddb



TOWER

3d PAN-MODULE-2
created by ddb

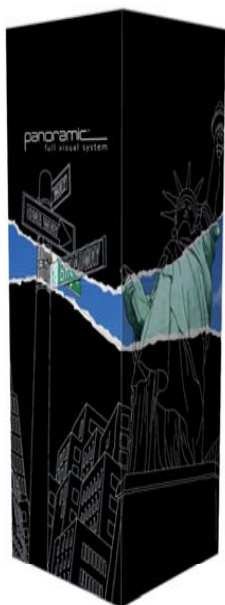

H 2000 x L 700



COUNTERS

3d PAN-COUNT-1
created by ddb



3d PAN-COUNT-2
created by ddb



3d PAN-COUNT-3
created by ddb



Complete designability



BOOTH 6x7

COMPLETE DESIGNABILITY

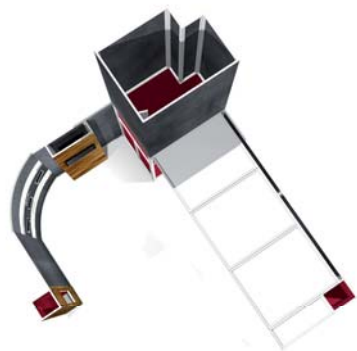

Patent Pending, Panoramic, Full Visual System and the logo feature a trademark.



panoramic respects the environment!

The aluminium structure is 100% recyclable, the dye-sublimation inks are solvent-free, and the product's minimal weight and volume limit its impact on greenhouse gas emissions.

www.panoramic-display.com